



SEPTIC TANK  
100 USER

3.3M. WIDE DRIVEWAY

SEPTIC TANK  
100 USER

3.3M. WIDE DRIVEWAY

S.U.G.W.R

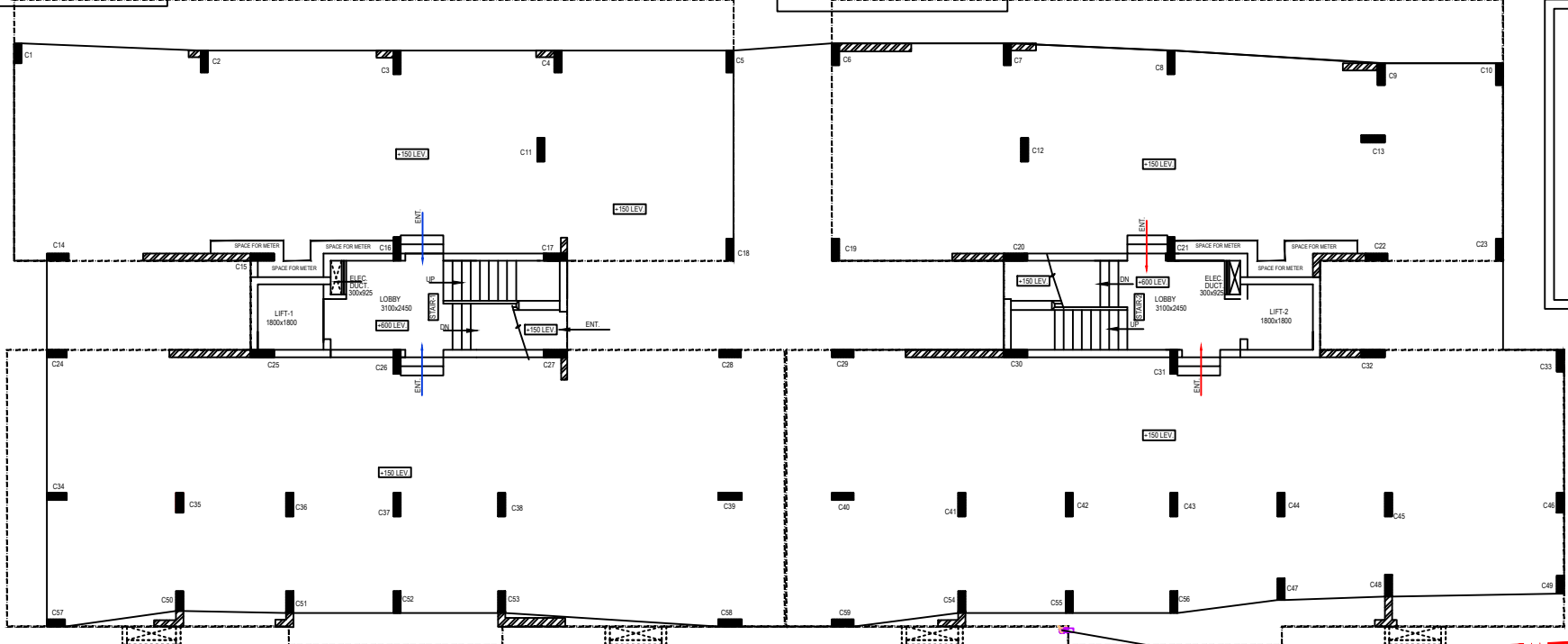

LATITUDE :- N 22° 36' 46.69"  
LONGITUDE :- E 88° 24' 36.48"

R O A D

PROJECT:  
Proposed G+VI storied residential building at premises no.-  
435/11, Jessore Road (Sbrumi Lane); kolkata-700055; under  
S.D.D.M. in ward no.- 21, Dist.- 24 pgs(n).

MUNICIPAL DRAIN

MUNICIPAL DRAIN

MUNICIPAL DRAIN

GROUND LEVEL PLAN  
SCALE-1:50